

# SAVETIX®

TURNS SCREWS INTO  
CAPTIVE FASTENERS

[www.savetix.de](http://www.savetix.de)

The best way to attach things with **SAVETIX®**



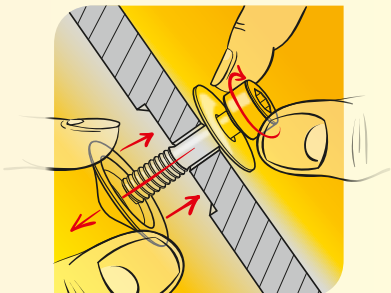

First put the screw through a flathead washer (if you are using one) and insert it through the protective guard you want to attach. Then put the Savetix® washer onto the screw from behind and screw the protective guard into position on the housing or frame.

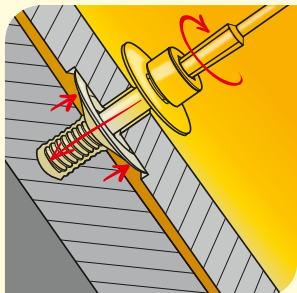

The Savetix® washer gets flattened during this process, making the hole smaller than the diameter of the threaded part of the thin-shank screw.

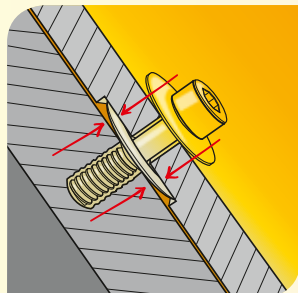

This deformation means that Savetix® has reduced the inner radius of the screw-hole so that the threaded part of the screw cannot fit back through the hole in the Savetix® washer or the protective guard.

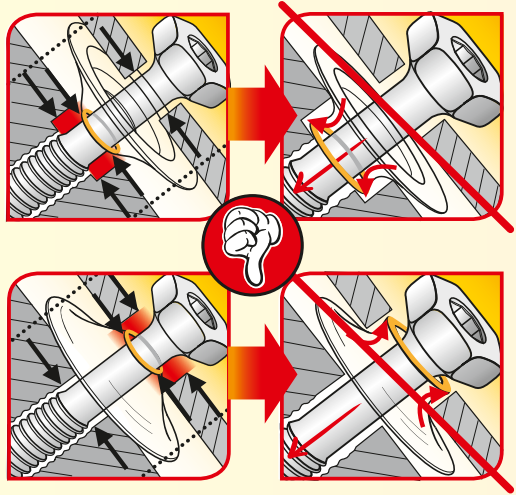
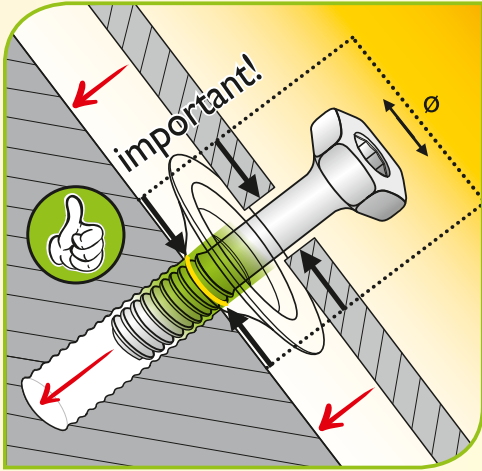



**Rudolf Rafflenbeul**

Stahlwarenfabrik GmbH & Co.

Eilper Straße 126-128 · 58091 Hagen (Germany)  
Phone +49 (0) 23 31 20 02-0 · Fax +49 (0) 23 31 2 1874

[www.rafflenbeul.de](http://www.rafflenbeul.de) · [www.savetix.de](http://www.savetix.de)

[verkauf@rafflenbeul.de](mailto:verkauf@rafflenbeul.de)